



18 Park Grange Court, Norfolk Park, Sheffield, S2 3SY

Saxton Mee

18 Park Grange Court

Norfolk Park

Guide Price

£240,000

GUIDE PRICE £240,000 - £250,000

Situated in the sought-after area of Norfolk Park, this spacious and well-presented four-bedroom semi-detached home offers modern living across three floors, ideal for families and professionals alike. Conveniently located close to local amenities, local schools, and excellent transport links, this property combines comfort with practicality in a desirable location.

The ground floor features a welcoming entrance hall with a downstairs W.C., internal access to the integral garage, and a generously proportioned kitchen/dining room that opens out to the rear garden—perfect for everyday family life and entertaining. The enclosed rear garden is laid to lawn, providing a safe and relaxing outdoor space for children and pets.

On the first floor, the bright and airy lounge offers a spacious retreat, while the impressive principal bedroom benefits from built-in storage and a modern en-suite shower room.

The second floor comprises three further bedrooms—two well-sized doubles and a fourth single bedroom or ideal home office—alongside a contemporary family bathroom.

Additional benefits include double glazing, gas central heating, and off-road parking via the driveway and integral garage.



- Four Bedrooms, Including En-Suite to Master
- Spacious Lounge & Modern Kitchen/Dining Room
- Ground Floor W.C. & Family Bathroom
- Rear Lawned Garden
- Integral Garage & Driveway
- Close to Local Amenities, Schools & Transport Links
- Tenure: Leasehold
- Council Tax Band: C
- Viewing's Via Banner Cross Branch





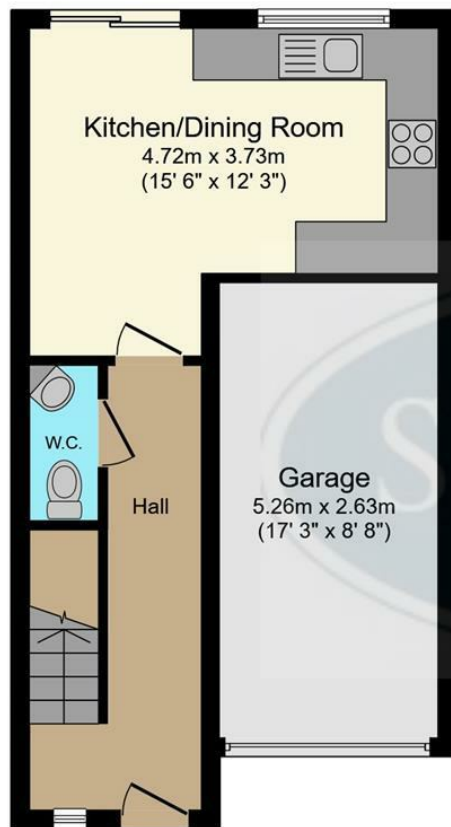

Ground Floor

Floor area 40.3 sq.m. (434 sq.ft.)

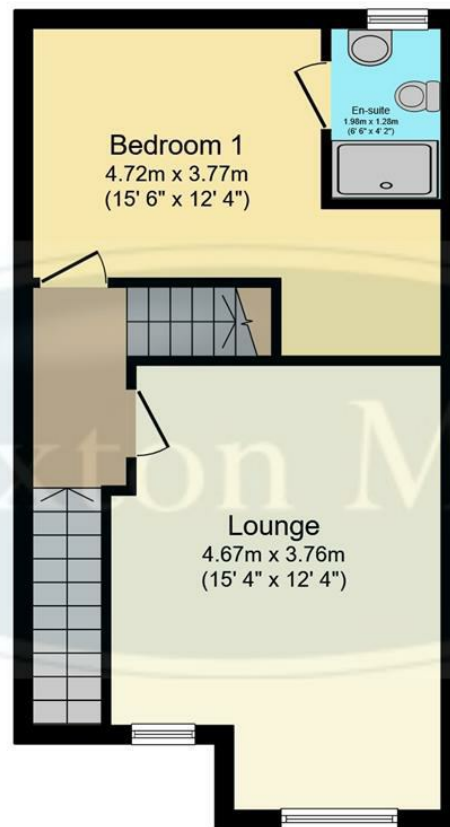

First Floor

Floor area 40.3 sq.m. (434 sq.ft.)

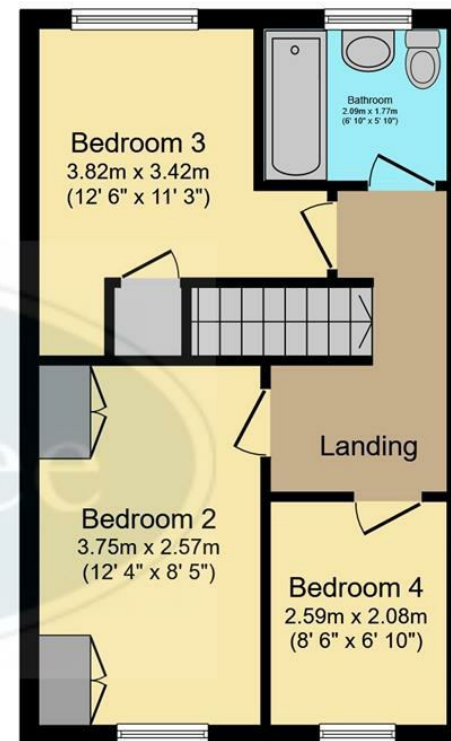

Second Floor

Floor area 38.0 sq.m. (409 sq.ft.)

Total floor area: 118.6 sq.m. (1,277 sq.ft.)

This floor plan is for illustrative purposes only. It is not drawn to scale. Any measurements, floor areas (including any total floor area), openings and orientations are approximate. No details are guaranteed, they cannot be relied upon for any purpose and do not form any part of any agreement. No liability is taken for any error, omission or misstatement. A party must rely upon its own inspection(s). Powered by www.Propertybox.io

While we endeavour to make our sales particulars fair, accurate and reliable, they are only a general guide to the property and, accordingly, if there is any point, which is of particular importance to you, please contact the relevant office. The Agents have not tested any apparatus, equipment, fittings or services and so cannot verify they are in working order. The buyer is advised to obtain verification. Please note all the measurement details are approximate and should not be relied upon as exact. All plans, floor plans and maps are for guidance purposes only and are not to scale. Under no circumstances should they be relied upon as exact or for use in planning carpets and other such fixtures, fittings or furnishings. YOUR HOME IS AT RISK IF YOU DO NOT KEEP UP REPAYMENTS ON A MORTGAGE OR OTHER LOAN SECURED ON IT. 'A Life Assurance policy may be requested.' 'Written Quotations of credit terms available on request.'

Banner Cross
T: 0114 268 3241
E: bannercross@saxtonmee.co.uk
www.saxtonmee.co.uk

Hathersage
T: 01433 650009
E: hathersage@saxtonmee.co.uk

Bakewell
T: 01629 815307
E: bakewell@saxtonmee.co.uk

Matlock
T: 01629 828250
E: matlock@saxtonmee.co.uk

